

TABLE OF CONTENTS

WHAT IS INCLUDED	1
WHAT IS COMPATIBLE	1
IMPORTANT SAFETY PRECAUTIONS.....	2
FEATURES.....	3
PARTS OF THE SYSTEM	3
THINGS TO CONSIDER	4
FUNCTIONS.....	4
WIRING DIAGRAM	5
MULTIPLE MONITOR WIRING DIAGRAM	6
MONITOR INSTALLATION & OPERATION	7
CAMERA INSTALLATION & OPERATION.....	8
SPECIFICATIONS	9

WHAT IS INCLUDED



1 Monitor



1 Camera



60' Extension
Wire



1 RCA Output
Converter



1 Power Adapter



1 Metal Mounting
Bracket

- 2 Window Warning Stickers
- Mounting Hardware
- 1 Year Warranty
- Instruction Manual
- Online/Toll Free Tech Support

WHAT IS COMPATIBLE

The VISS7500 is compatible with TVs, VCRs, DVRs, computers and other SVAT systems including:



VISS7500M



ClearVu DVRs



Any TV or VCR

IMPORTANT SAFETY PRECAUTIONS

PLEASE READ BEFORE INSTALLING

- Keep the camera, monitor and AC/DC adapter cords out of reach of children.
- Do not place the camera, monitor and AC/DC adapter cords in a crib or playpen.
- Do not use the camera near water or damp and wet environments, such as a bathtub, laundry tub, kitchen sink, or wet basements.
- Locate the camera, monitor and AC/DC adapters where there is adequate ventilation. Do not locate the camera in direct sunlight.
- Do not locate the camera, monitor and AC/DC adapters near heat sources such as heat registers, radiators, ovens, furnaces or other appliances with high operating temperatures.
- Do not use with extension cords. Use only the AC/DC adapters provided with this system. ***Note: Use of other adapters may damage the units and void your warranty.
- Only plug components into standard household voltage outlets (110VAC, or 60Hz).
- Do not place cords from the AC/DC adapters, camera or monitor where they can be pinched or stepped on. Protect the cords by keeping them out of the way of children, pets and routine household traffic. Do not place heavy objects on power cords or cover cords with rugs or carpet.
- When cleaning, use a DRY, lint-free cloth. Unplug the camera, monitor and AC/DC adapters before cleaning. NEVER immerse any components in water and do not spray cleaners or solvents on the units. Doing so may damage the units or cause electrical shock.
- Unplug the AC/DC adapters from the wall outlet when the system is not in use.
- Mishandling, alterations or modifications not approved by the manufacturer will void the warranty.

CAUTION!

- Connect this unit **ONLY** to other compatible units. Do not connect it to any other type of alarm or auxiliary device. Connecting anything else to this unit may damage it or prevent it from operating properly.
- Do not paint over the camera.

IMPORTANT!

ACCESSORIES- Do not place video monitor or equipment on an unstable cart, stand or table. The video monitor or equipment may fall causing serious injury to a child or adult, and serious damage to the equipment. Wall mounting should follow the manufacturer's instruction, and should use a mounting kit approved by the manufacturer.

VENTILATION

Slots and openings in the monitor and the back or bottom are provided for ventilation and to ensure reliable operation of the video monitor or equipment and to protect it from overheating. These openings must not be blocked or covered. The openings should never be blocked by placing the video monitor on a bed, sofa, rug, or other similar surface. Video monitor should never be placed near or over a radiator or heat register. Video monitor should not be placed in a built-in installation such as a bookcase unless proper ventilation is provided.

FEATURES

- Sleek and ultra thin monitor design
- Two wire connection allows you to use the existing wire from your doorbell for easy installation
- 5" TFT-LCD color screen
- Two way communication
- 12-14V doorstrike capabilities (doorstrike not included)
- Warning alarm siren
- Monitor can be wall mounted or laid flat

PARTS OF THE SYSTEM

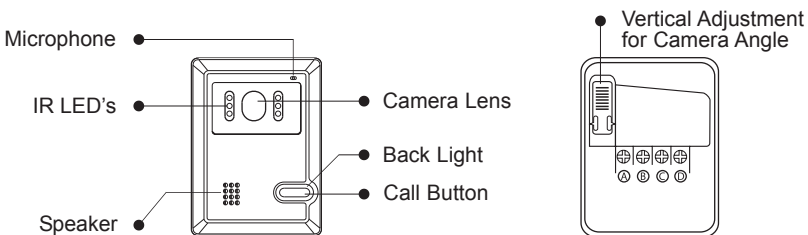
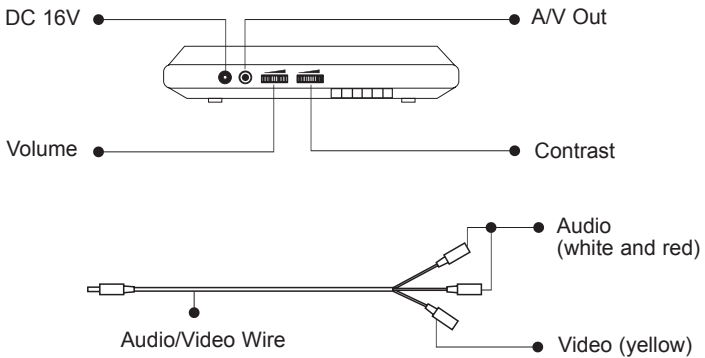
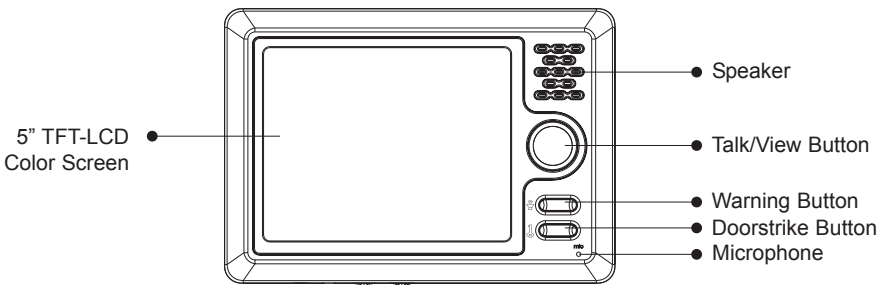

THINGS TO CONSIDER BEFORE INSTALLATION

- Do not place the intercom system near strong magnetic fields, such as televisions and video recorders.
- Turn off the video intercom system power if not in use for long periods of time.
- Do not place the video intercom system in direct sunlight.
- Do not disassemble this device freely, there are high voltage flows inside the system that can cause bodily harm.

FUNCTIONS

VIDEO INTERCOM

- The device provides audio/video communication between the indoor monitor and the outdoor camera. The picture of the visitor can be seen clearly through the indoor monitor. It is artistically designed and an ideal choice for the modern family.

HIGH RESOLUTION PICTURE

- The high resolution camera and 5" TFT-LCD screen will provide clear vivid images.

NIGHT OPERATION

- The IR LEDs on the camera allow you to view your visitors at night in total darkness.

AUTOMATIC IMAGE DISPLAY

- When the visitor presses the call button, the built-in bell in the monitor will ring and the picture of the visitor will automatically display. To engage in a conversation with the visitor simply press the Talk/View button.

UNLOCK BUTTON

- With a simple press of a button you are able to open the door from the monitor without going to the door directly. (Door strike not included)

SIMPLE INSTALLATION

- The connection between the camera and the monitor is a simple 2 wire connection without polarity (wires can be reversed)

WIRING DIAGRAM

Be sure to disconnect the power before connecting the wires

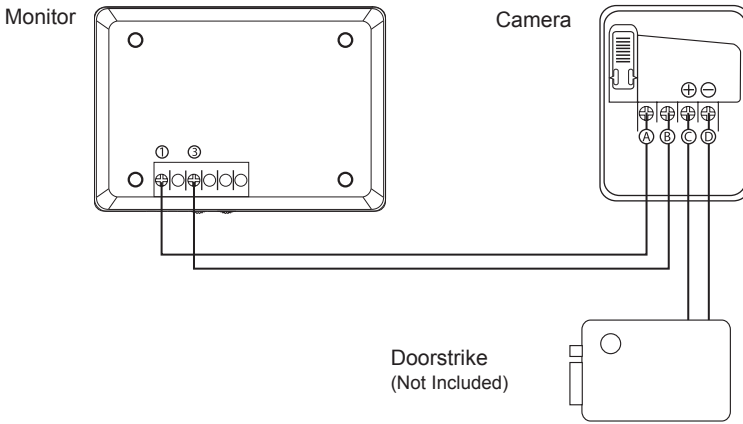

Important Notes

- Wires are color coded and are interchangeable.

Make sure the wire that is connected to Pin 1 on the monitor is connected to Pin A on the camera.

Also make sure the wire connected to Pin 3 on the monitor is connected to Pin B on the camera.

- Pins C and D on the camera are for use with the doorstrike. (Doorstrike not included)
Pin C is "Positive" and Pin D is "Negative"
- This system can support up to 3 separate separate monitors for 1 camera doorbell station. (Extra monitors (7500M) not included)

Wiring diagram for multiple monitors found on next page!

WIRING DIAGRAM FOR MULTIPLE MONITORS

Be sure to disconnect the power before connecting the wires

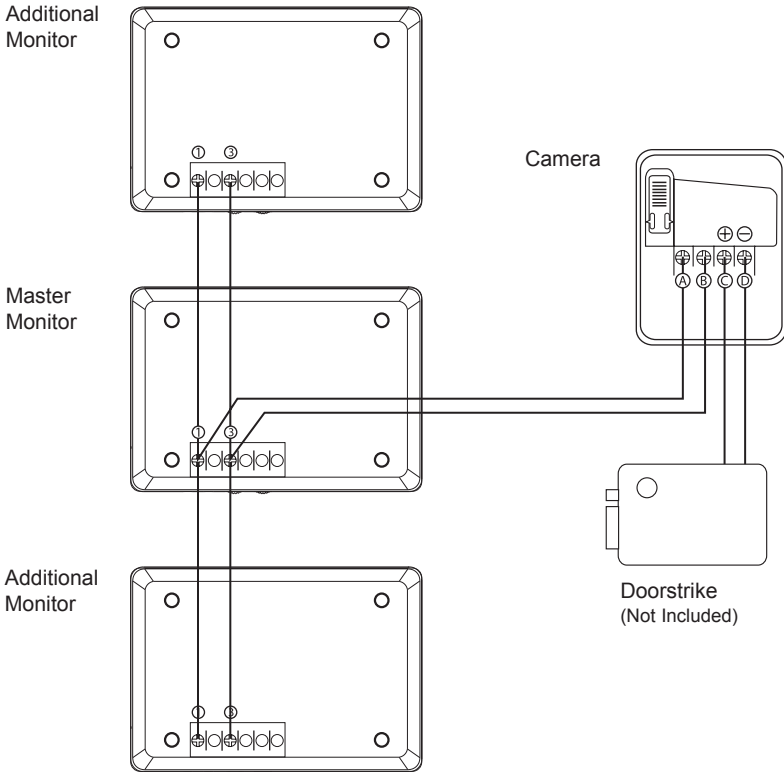

Important Notes

- Wires are color coded and are interchangeable.

Make sure the wire that is connected to Pin 1 on the monitor is connected to Pin A on the camera.

Also make sure the wire connected to Pin 3 on the monitor is connected to Pin B on the camera.

- The additional monitors can be wired from the Master Monitor itself or they can be wired back to the camera as well.

The wires for all monitors must be connected to the corresponding Pins as mentioned above. Wires are color coded for easy identification.

MONITOR INSTALLATION & OPERATION

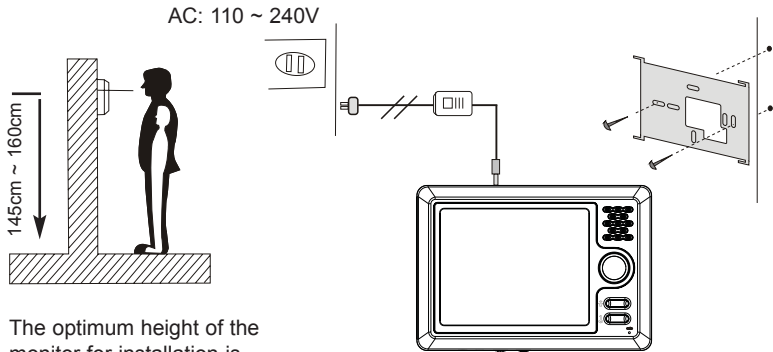

The optimum height of the monitor for installation is 145cm ~160cm from the center of the pick-up tube of the monitor to the ground.

Take two screws and fix the support of the wall-mount on the wall and then install the monitor.

USING THE MONITOR

- When the monitor is in standby, pressing the Talk/View button turns the monitor and outside camera ON. Monitor and camera will automatically turn off after 1 minute.

NOTE The camera's CALL button must be pressed first by the visitor, followed by the Talk/View button in order to speak with your visitor.

DETECTING UNWANTED VISITORS

- If you discover unwanted visitors, pressing the WARNING button on the monitor will engage a loud siren in the outside camera in order to deter the visitor.

ADJUSTING PICTURE/VOLUME

- Volume and Brightness knobs are located at the bottom of the monitor for fine tuning.

DOORSTRIKE

- This system supports any door strike rated between 12-14V DC. The door will remain unlocked for 10 seconds. Please refer to the wiring diagram for installation. (Doorstrike not included)

CAMERA INSTALLATION & OPERATION

POSITIONING

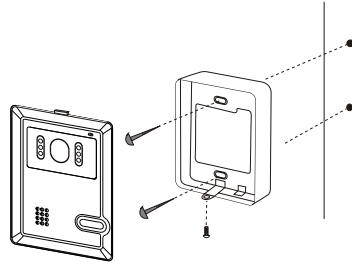
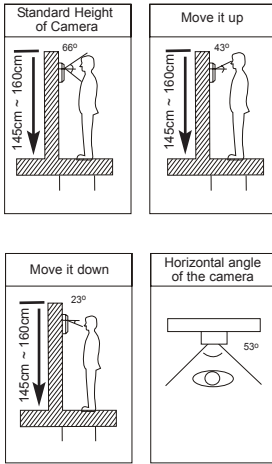

LOCATION

Keep the camera away from direct sunlight or any other bright light sources.

USING THE CAMERA

- Press the CALL button on the camera
- Picture of the visitor is displayed on the indoor monitor
- In order to communicate with the visitor press the TALK/VIEW button.
- By pressing the UNLOCK button, you can also open the doors for your visitor without getting up (this feature requires an installed door strike, not included).

NOTE The camera's CALL button must be pressed first by the visitor, followed by the Talk/View button in order to speak with your visitor.

CONNECTING TO A TV

You can connect the monitor to your television/DVR/VCR for viewing and recording purposes. You will need to purchase a separate composite RCA cable (red, white and yellow). Follow these instructions:

1. Plug the included RCA adapter into the monitor
2. Plug the RCA cable into the jacks on the end of the RCA adapter.
3. Plug the RCA cable into the inputs of your television/DVR/VCR.
4. Make sure the television is on the INPUT channel.
5. Whenever video is displayed on the system's monitor, it will also be displayed on your TV.

SPECIFICATIONS

INDOOR MONITOR

Power Supply	DC16V
Power Consumption	10W in operation, 0.5W standby
Operation Temperature	5°F ~ 122°F
Conversation System	Bi-directional through receiver
Calling Tone	“Ding Dong” chime
Conversation Time	Automatic cut off after 1 minute
Scanning Frequency	Horizontal: 15.625KHz Vertical: 50Hz
External dimension	7.2" x 5.1" x 1"
Max Wiring Distance	300ft (Monitor to the Camera)
Resolution	480 x 234 dpi
Door Strike Voltage	12 Volts for 5 seconds

CAMERA

Power Supply	DC12V, 0.25A (supplied by monitor)
Power Consumption	2W in operation
Operation Temperature	5°F ~ 122°F
Picture Sensor	1/4" lens
Imagery Angle	Diagonal: 53
Min. Lighting	0.1 lux at 30cm
Infrared LED's	6
External Dimension	4.7" x 3.4" x 1.3"
Max Wiring Distance	300ft (Camera to the Monitor)
Camera Sensor	1/4" CMOS Lens
Resolution	380 TV Lines